

Everest Line Single Convector Type 11

Height mm	Length mm	Henrad Code	Heat emissions	
			Watts	Btu/hr
300	500	3031105	235	802
	1000	3031110	469	1601
	1500	3031115	704	2401
500	400	3051104	298	1017
	600	3051106	448	1530
	700	3051106	522	1781
	800	3051108	598	2040
	900	3051109	671	2289
	1000	3051110	746	2545
	1100	3051111	821	2801
	1200	3051112	897	3060
	1400	3051114	1046	3570
	1600	3051116	1194	4075
	1800	3051118	1343	4584
600	400	3061104	348	1188
	600	3061106	522	1782
	700	3061107	609	2078
	800	3061108	696	2375
	900	3061109	783	2672
	1000	3061110	870	2969
	1100	3061111	957	3265
	1200	3061112	1044	3563
	1400	3061114	1219	4158
	1600	3061116	1392	4751
	1800	3061118	1566	5345
2000	3061120	1741	5939	

Btu/hr @ $\Delta t50^{\circ}\text{C}$

Everest Line Type 11



Everest Line Double Convector Type 22

Height mm	Length mm	Henrad Code	Heat emissions	
			Watts	Btu/hr
300	500	3032205	465	1587
	1000	3032210	929	3171
	1500	3032215	1394	4756
500	400	3052204	555	1894
	600	3052206	833	2843
	700	3052207	972	3316
	800	3052208	1110	3788
	900	3052209	1249	4262
	1000	3052210	1388	4737
	1100	3052211	1527	5210
	1200	3052212	1666	5686
	1400	3052214	1943	6631
	1600	3052216	2222	7580
	1800	3052218	2499	8526
600	400	3062204	640	2184
	600	3062206	961	3280
	700	3062207	1121	3825
	800	3062208	1281	4372
	900	3062209	1441	4917
	1000	3062210	1601	5464
	1100	3062211	1761	6009
	1200	3062212	1921	6556
	1400	3062214	2241	7649
	1600	3062216	2563	8744
	1800	3062218	2883	9836
2000	3062220	3203	10928	

Btu/hr @ $\Delta t50^{\circ}\text{C}$

Everest Line Type 22



Have you considered Plan?

Technical information

Testing and Operating Pressures

Henrad Everest Line has been independently tested to ensure these radiators perform to a maximum working pressure of 10.0 bar.

Connections

Henrad Everest Line has 4 x 1/2" BSP connections as standard.

Paint Process

Two coat paint process, each Henrad radiator is subjected to a multi-stage cleaning and paint process.

The final powder coat is Traffic white (RAL A9016) which is stoved and cooled to give a perfect finish. All radiators are illustrated in Traffic white unless stated.

Water Treatment

Installation of the system should be properly flushed and fitted in accordance with the British Code of Practice for the Treatment of Water in Domestic Hot Water Central Heating Systems.

Warranty

Henrad Everest Line comes with a 5 year manufacturer's warranty.



For technical and installation information visit our website www.henrad.co.uk/downloads

Henrad (UK) Limited, Marriott Road,
Mexborough, South Yorkshire S64 8BN.
Telephone: 0800 876 6813

www.henrad.co.uk

Henrad Everest Line

Wall Mounting Information

All dimensions in mm.

T11

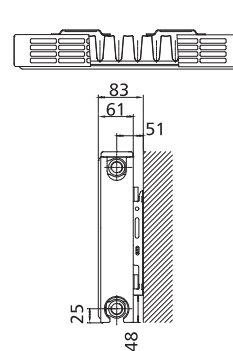

T22

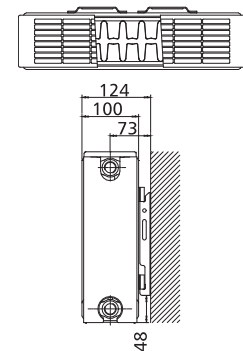

Mounting Bracket Information

All dimensions in mm.

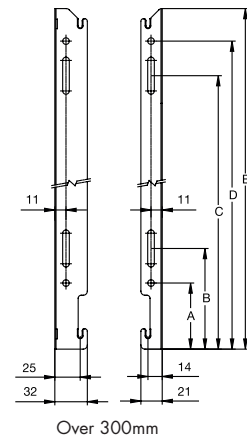
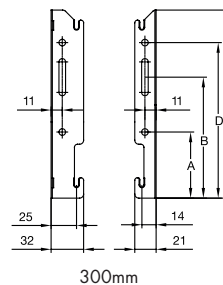

All dimensions in mm.

Height	500	600
A	65	65
B	99	99
C	319	419
D	333	453
E	385	485

T11 & T22 Lug Positions

All dimensions in mm.

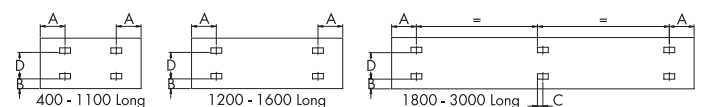

Panel Height	D	
mm	mm	mm
500	355	
600	455	

T22		T11	
Dimensions	mm	Dimensions	mm
A	133	A 400mm	117
B	60	A 500 - 3000mm	150
		B 400 - 3000mm	60
		C 1800 - 3000mm	17