



Silhouette Concept Type 11

**NEW** Silhouette Concept

Single Convector Type 11

Height mm	Length mm	Henrad Code	Heat emissions	
			Watts	Btu/hr
<b>600</b>	400	50601104	348	1187
	600	50601106	522	1781
	800	50601108	696	2375
	1000	50601110	870	2968
	1200	50601112	1044	3562
	1400	50601114	1218	4156

Btu/hr @  $\Delta t50^{\circ}\text{C}$

**NEW** Silhouette Concept

Double Convector Type 22

Height mm	Length mm	Henrad Code	Heat emissions	
			Watts	Btu/hr
<b>600</b>	400	50602204	640	2184
	600	50602206	961	3279
	800	50602208	1281	4371
	1000	50602210	1601	5463
	1200	50602212	1921	6554
	1400	50602214	2241	7646

Btu/hr @  $\Delta t50^{\circ}\text{C}$

Working pressure:  
Tested to withstand 8.0 bar



For technical and installation  
information visit our website  
[www.henrad.co.uk/downloads](http://www.henrad.co.uk/downloads)



Silhouette Concept is only available  
in Slate grey RAL A7015.

## Technical information

### Testing and Operating Pressures

Henrad Silhouette Concept has been independently tested to ensure these radiators perform to a maximum working pressure of 8.0 bar.

### Connections

Henrad Silhouette Concept has 4 x 1/2" BSP connections as standard.

### Paint Process

Two coat paint process, each Henrad radiator is subjected to a multi-stage cleaning and paint process.

The final powder coat is Slate grey (RAL A7015) which is stoved and cooled to give a perfect finish.

### Water Treatment

Installation of the system should be properly flushed and fitted in accordance with the British Code of Practice for the Treatment of Water in Domestic Hot Water Central Heating Systems.

### Warranty

Henrad Silhouette Concept comes with a 5 year manufacturer's warranty.

Henrad (UK) Limited, Marriott Road,  
Mexborough, South Yorkshire S64 8BN.  
Telephone: 0844 543 6200 Facsimile: 0844 543 6300

[www.henrad.co.uk](http://www.henrad.co.uk)

## Henrad Silhouette Concept

### Wall Mounting Information

All dimensions in mm.

T11

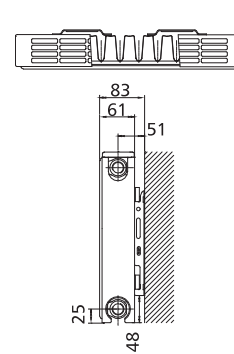

T22

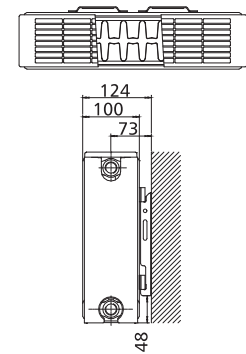

### Mounting Bracket Information

All dimensions in mm.

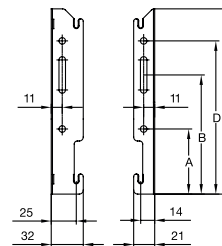

300mm

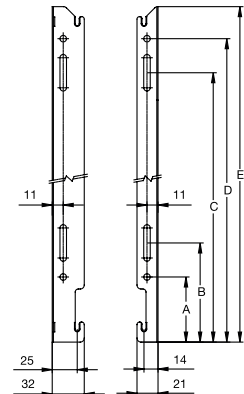

Over 300mm

All dimensions in mm.

Height	500	600
A	65	65
B	99	99
C	319	419
D	333	453
E	385	485

### T11 & T22 Lug Positions

All dimensions in mm.

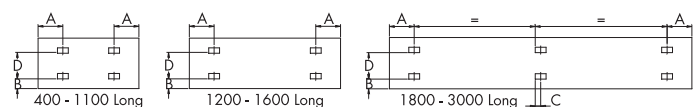

Panel Height	D	
mm	mm	mm
500	355	
600	455	

T22	T11		
Dimensions	mm	Dimensions	mm
A	133	A 400mm	117
B	60	A 500 - 3000mm	150
		B 400 - 3000mm	60
		C 1800 - 3000mm	17